

Quantities
 235 lin ft 8" V.C.P.
 64 lin. ft. 4" V.C.P.
 1 type "C" Manhole
 1 Cleanout

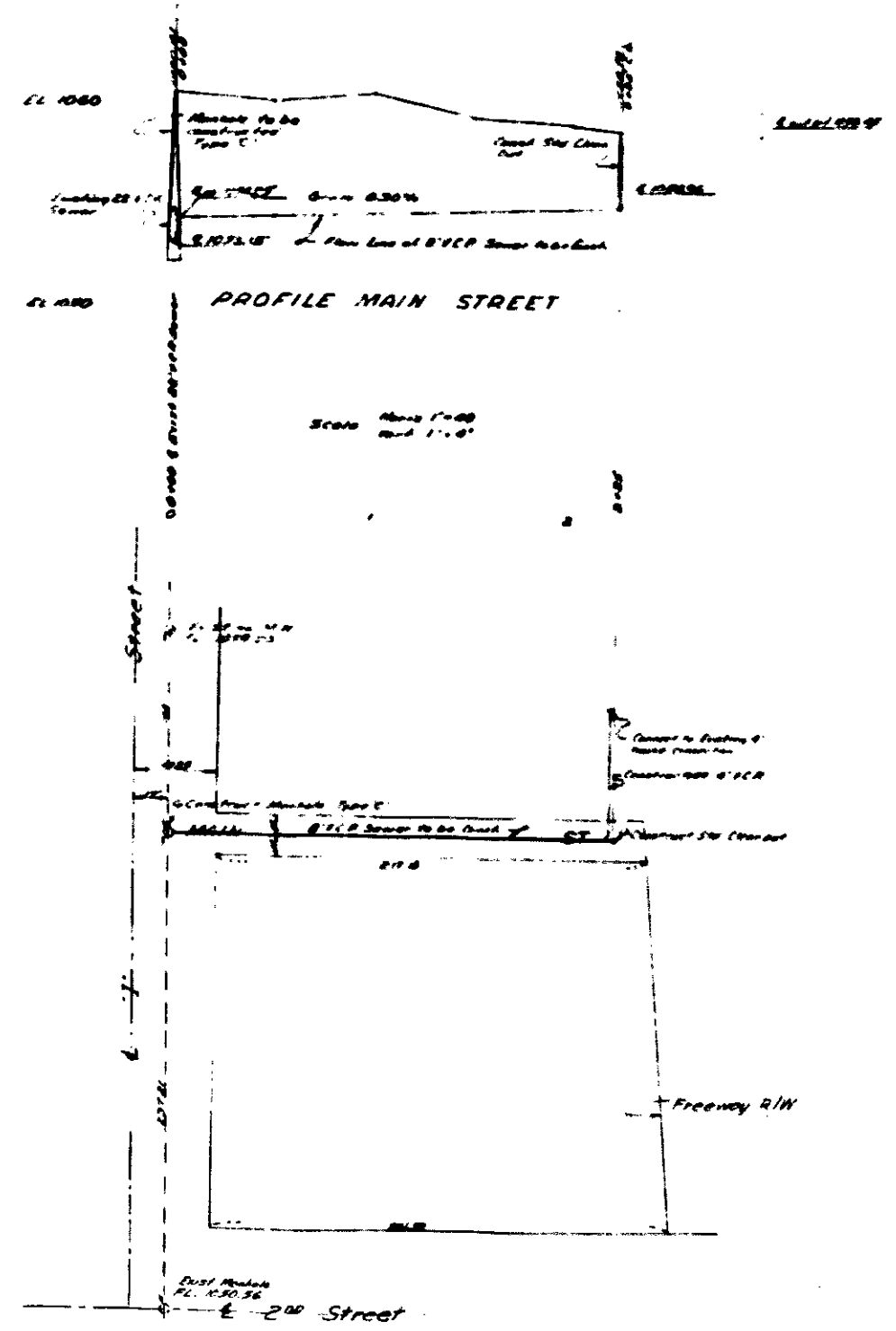

B.M. Nail in curb by File # 99625E
 North 1/4 Sec 34 West of 171 SE RR.
 274.10 RB. IN M.S.L.

DEPARTMENT OF ENGINEERING
 CITY OF SAN BERNARDINO
 Sewer
 Main Street - 1" St to apt 235 East

DESIGNED BY: December 26, 1956
 DRAWN BY: ARW
 CHECKED BY: R.E. Wolfe
 REG. CIVIL ENGINEER NO 9879
 SHEETS: 1 OF 1

Quantities
 235 lin ft 8" V.C.P.
 64 lin. ft. 4" V.C.P.
 1 type "C" Manhole
 1 Cleanout

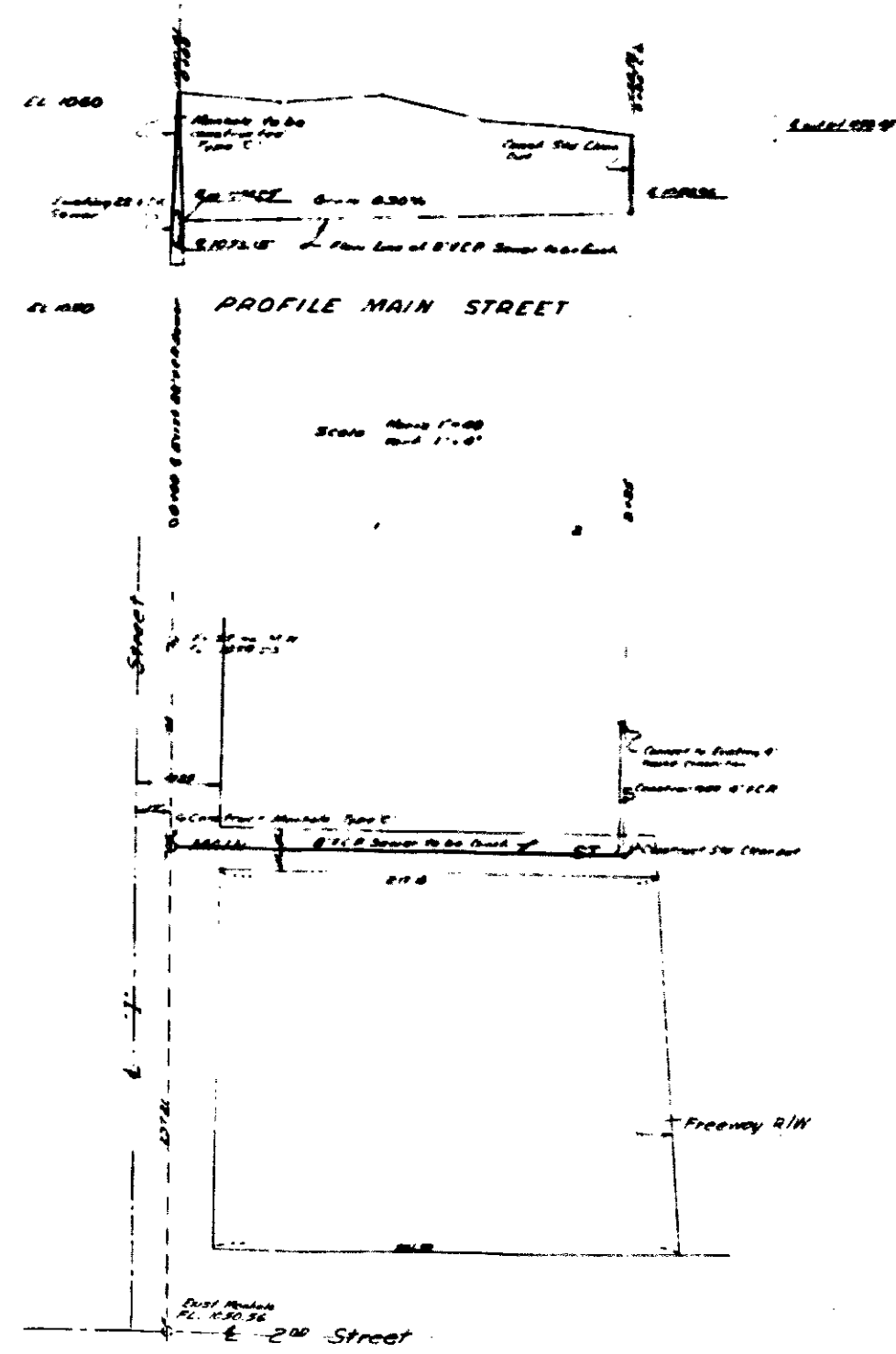

B.M. Nail in curb by File # 99635E
 North 1/4 Sec 51 West of 171 SE RR.
 274.1080 M.S.L.

DEPARTMENT OF ENGINEERING
 CITY OF SAN BERNARDINO
 Sewer
 Main Street - 1/2 St to apt 235 East

DESIGNED BY: December 26, 1956
 DRAWN BY: ARW
 CHECKED BY: R.E.C.
 SHEETS: 2376

Quantities
 235 lin ft 8" V.C.P.
 64 lin. ft. 4" V.C.P.
 1 type "C" Manhole
 1 Cleanout

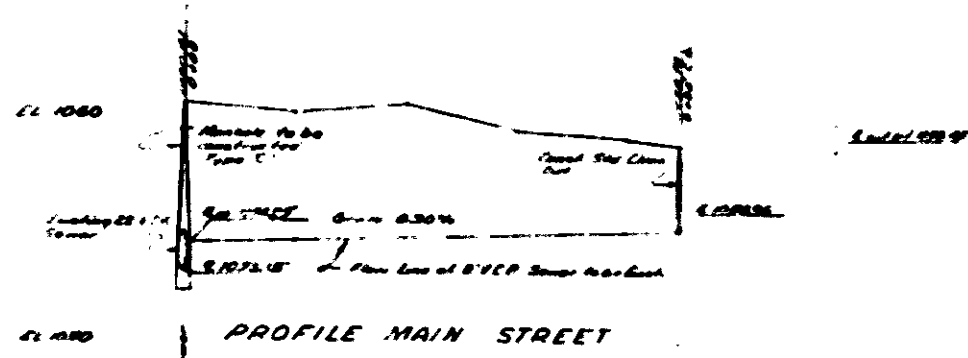

B.M. Nail in curb by File # 99635E
 North 1/4 Sec 51 West of 171 SE RR.
 274 10.00.01 M.S.L.

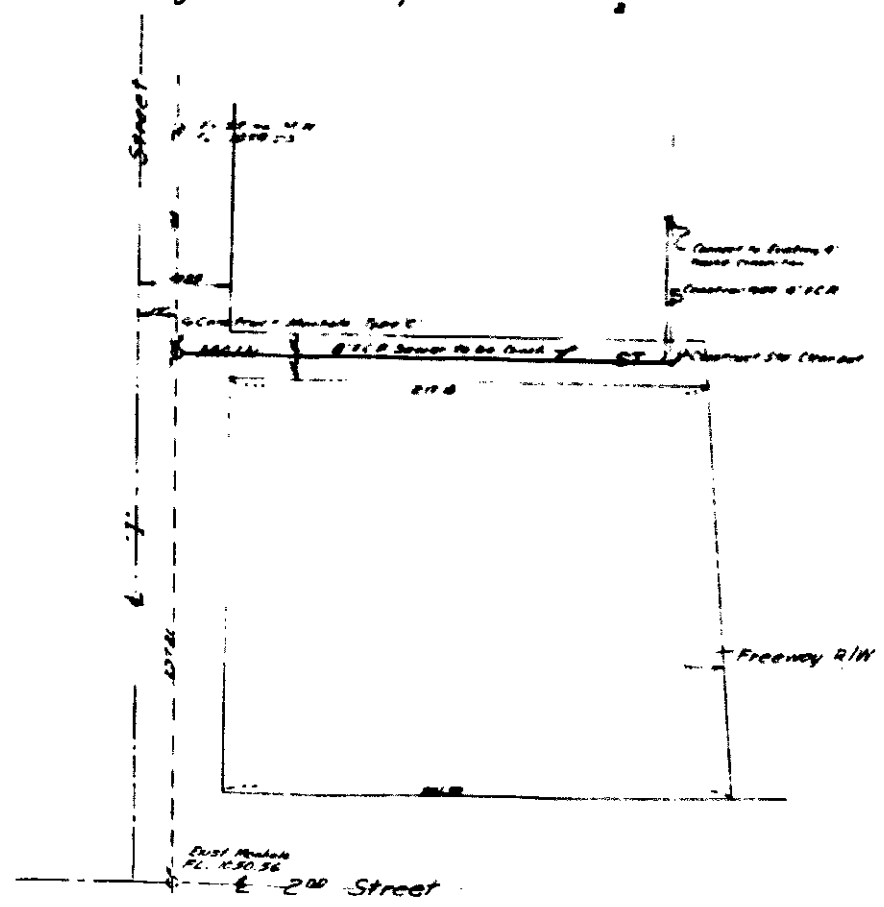

DEPARTMENT OF ENGINEERING
 CITY OF SAN BERNARDINO

Sewer
 Main Street - 1" St to apt 235 East

DESIGNED BY: December 26, 1956
 DRAWN BY: ARW
 CHECKED BY: R.E. Wolff
 REG. CIVIL ENGINEER NO 9879
 SHEETS: 1 OF 1